



Capital Project Workshop

January 30, 2017

Synthesis Architects

Jim Graham, RA
Principal

Calvin Rugg, RA
Project Architect

M/E Engineering

Bob Abromaitis
Project Manager/Senior Engineer

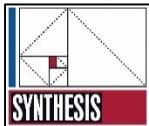

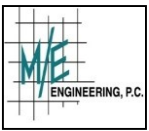
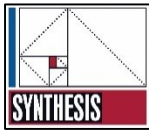

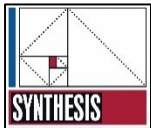
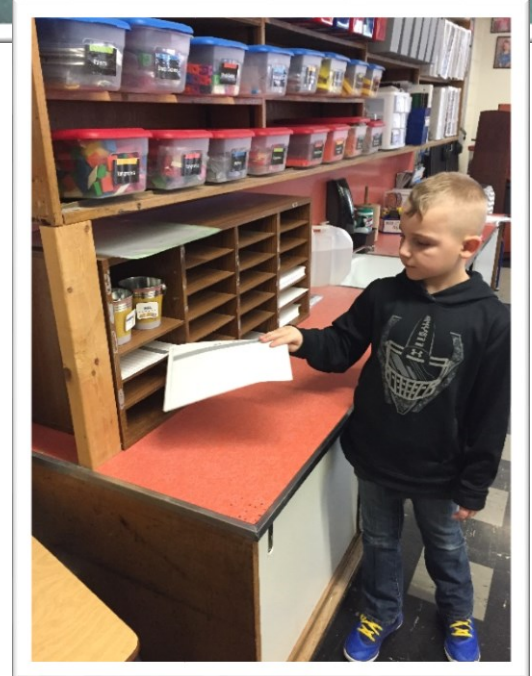



RECAP

December 2016 Presentation

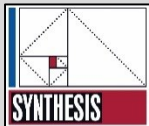
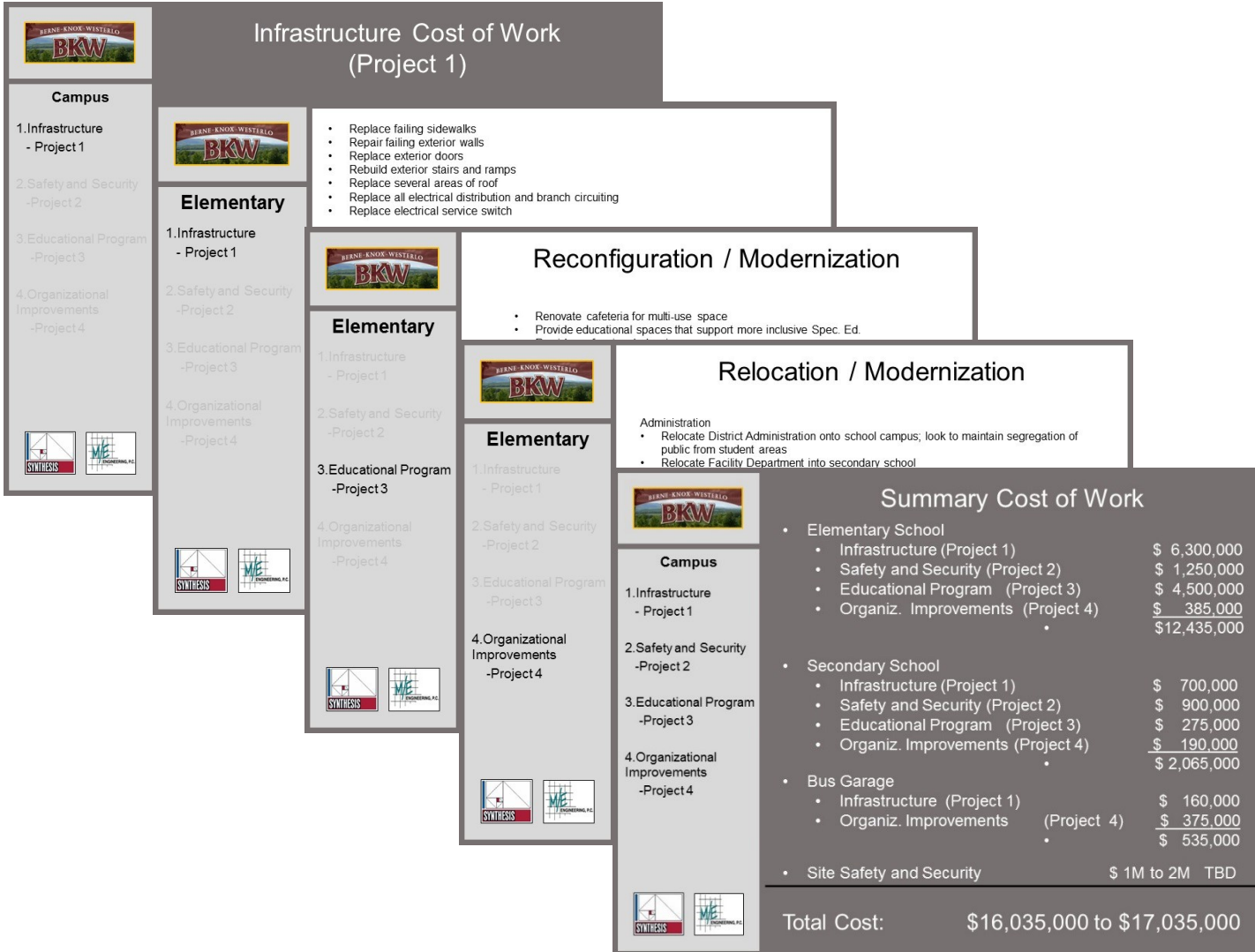



RECAP

January 2017 Security Walking Meeting

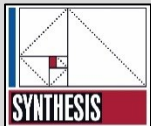



WORKSHOP

January 30, 2017

GOALS:

- Discuss the Board's and Administration's Vision.
- Gain an understanding of how program areas were viewed and developed in the preliminary listing of project scope.
- Provide the design team direction at the conclusion of the workshop.

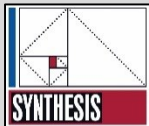



Reconfiguration / Modernization

Elementary

- • Renovate cafeteria for multi-use space
- Provide educational spaces that support more inclusive Spec. Ed.
- • Provide professional planning spaces
- Improve opportunities for grade level collaboration (1-1-1, 2-2-2, through 5th)
- Improve early elementary access to support services (speech, resource)
- • Create dedicated elementary science space



Lower Floor Plan

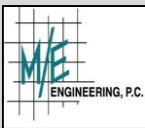
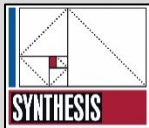



Primary Classrooms

Tier 1

- Very limited scope beyond Building Condition Survey corrective work



Tier 2

- Classroom modernizations to include spaces that support the requested programmatic advancements

Tier 3

- Gut renovation that supports large scale programmatic changes

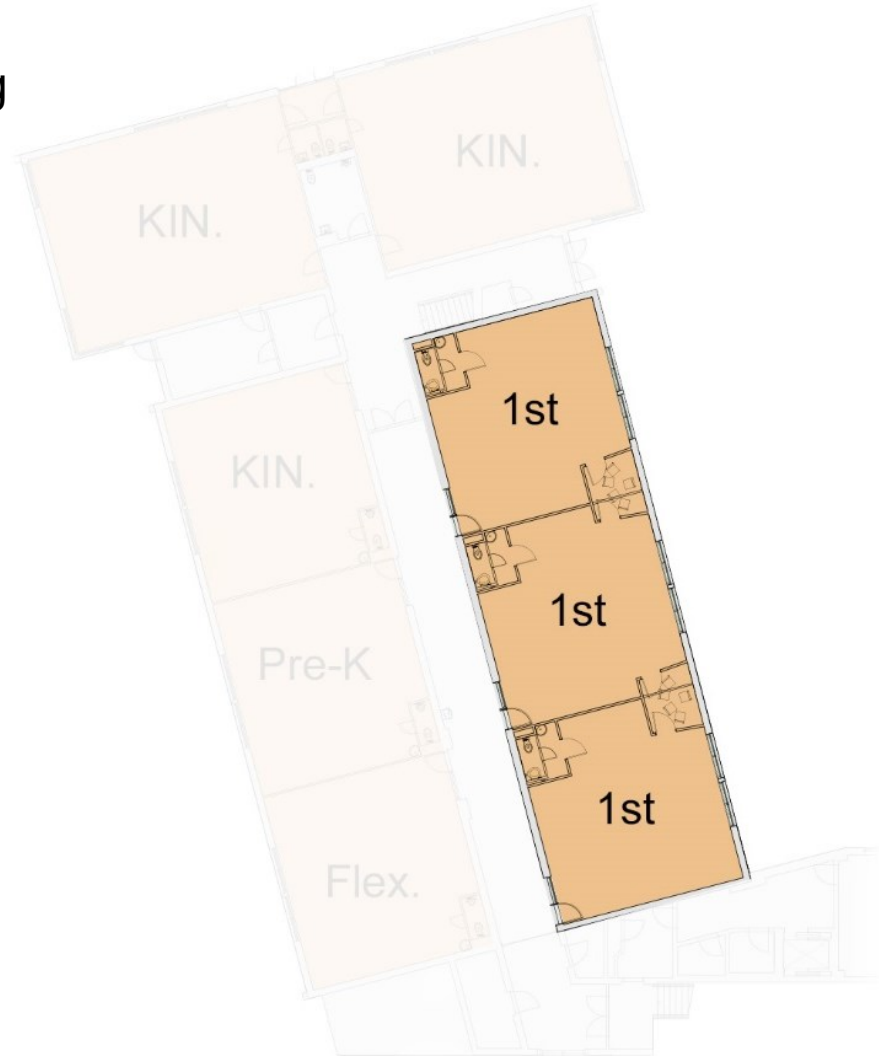

Lower Floor Plan

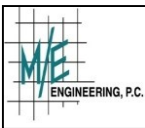
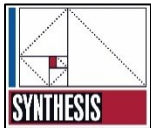



Tier 1 and 2 Comparison

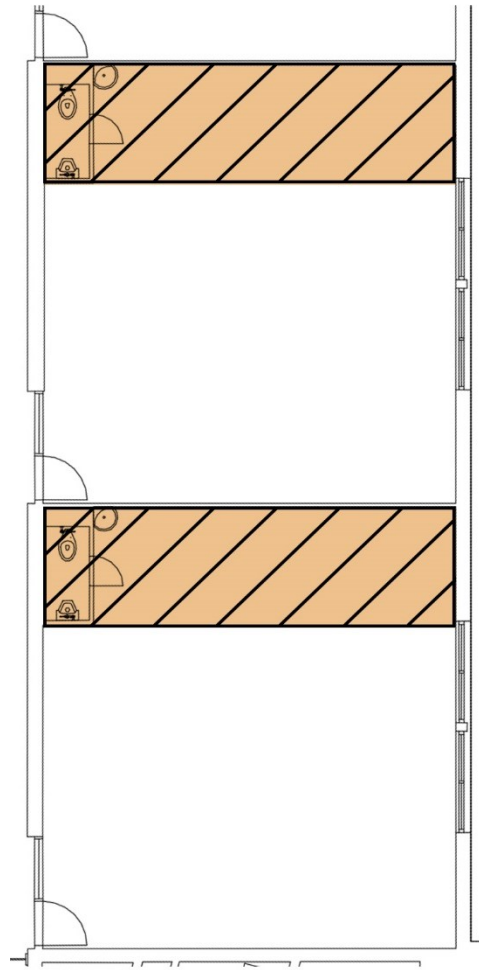
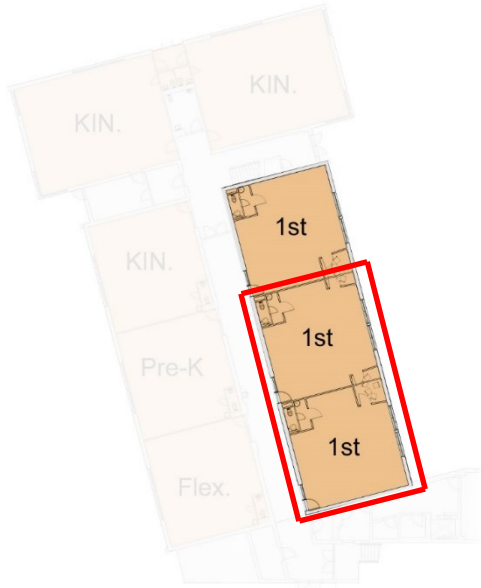

Tier 1

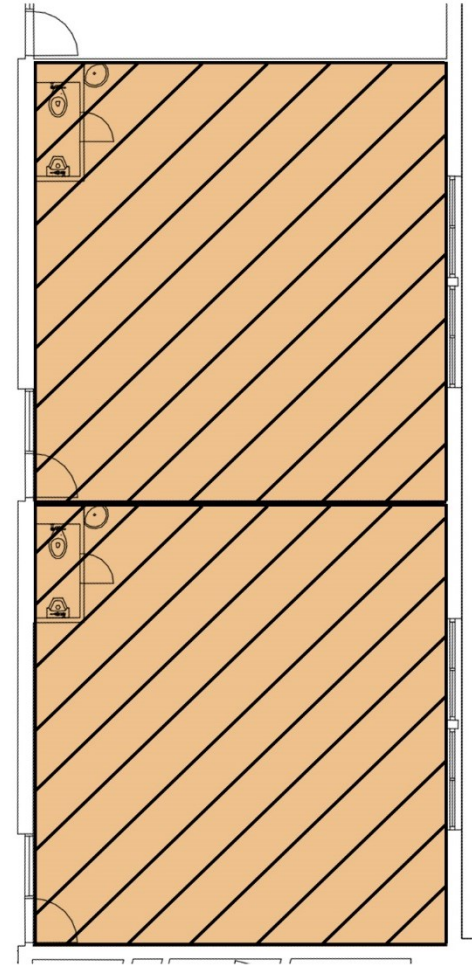

Tier 2

Key Plan

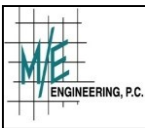
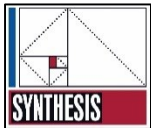

Example: 1955 Classrooms



Primary Classrooms

Tier 1 Renovations

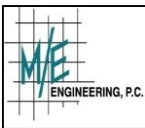
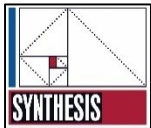



Primary Classrooms

Tier 1 Renovations

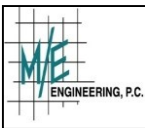
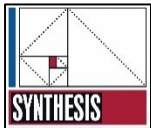



Primary Classrooms

Tier 1 Renovations

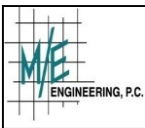
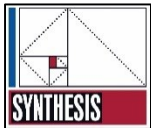



Primary Classrooms

Tier 2 Renovations

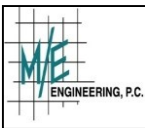
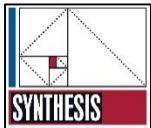
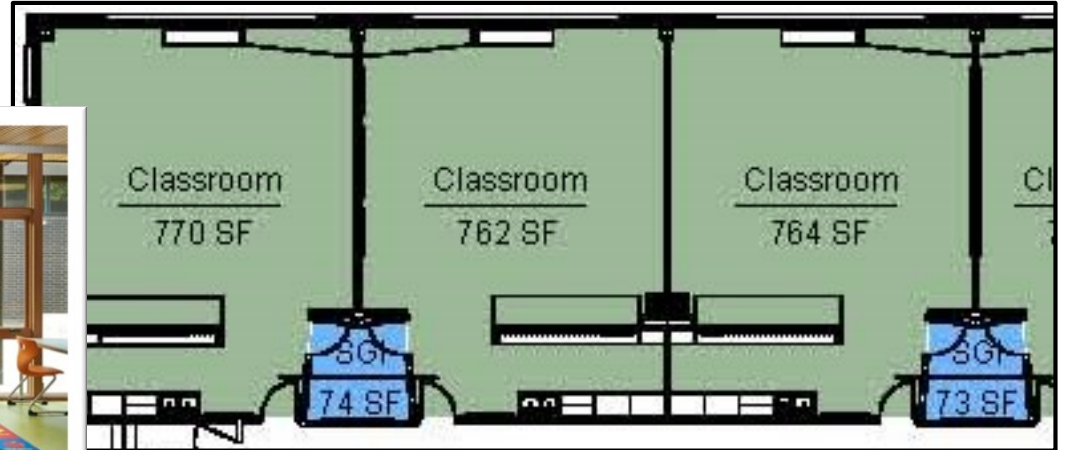



Primary Classrooms

Tier 2 Renovations

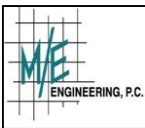
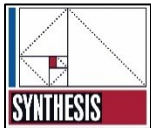

Case Study: Duanesburg Elementary



Primary Classrooms

Tier 2 Renovations

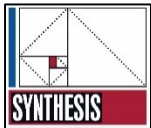
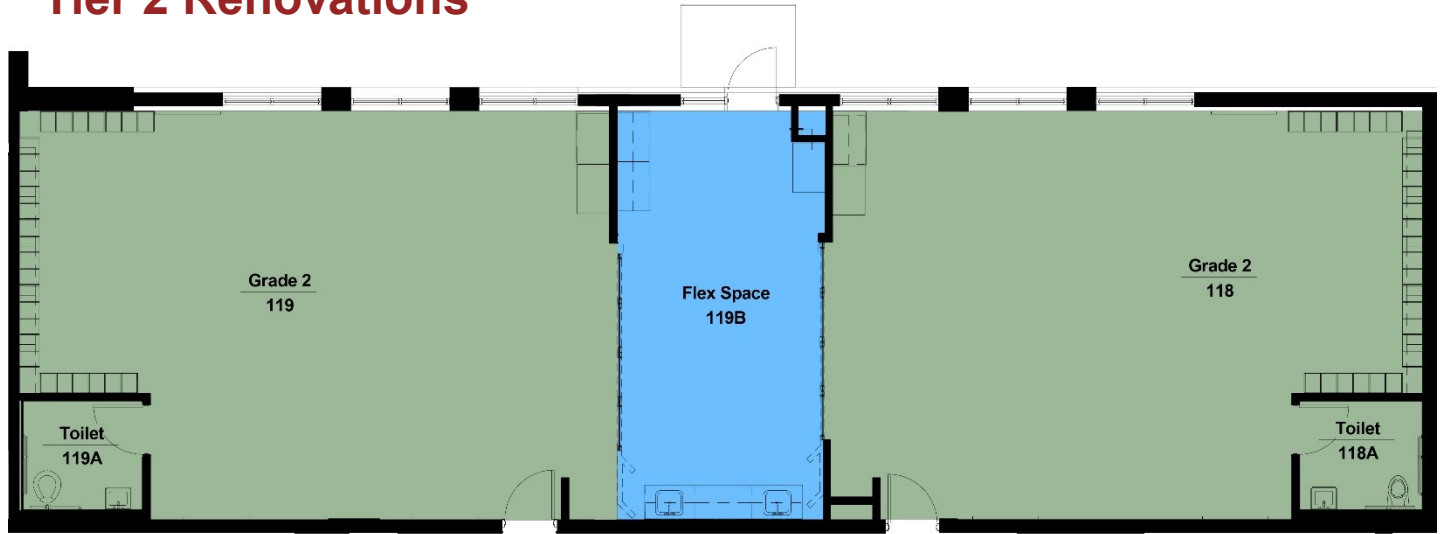

Case Study: Duanesburg Elementary



Primary Classrooms

Tier 3 Renovations

Case Study:

**Forest Ave. Elementary
Middletown, Rhode Island**



**Traditional New York State
Classroom Exhibit
New York State Museum**

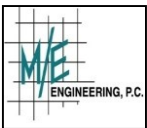
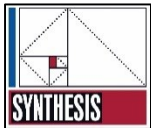



Cafeteria

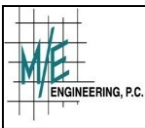
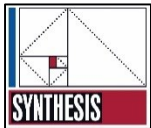
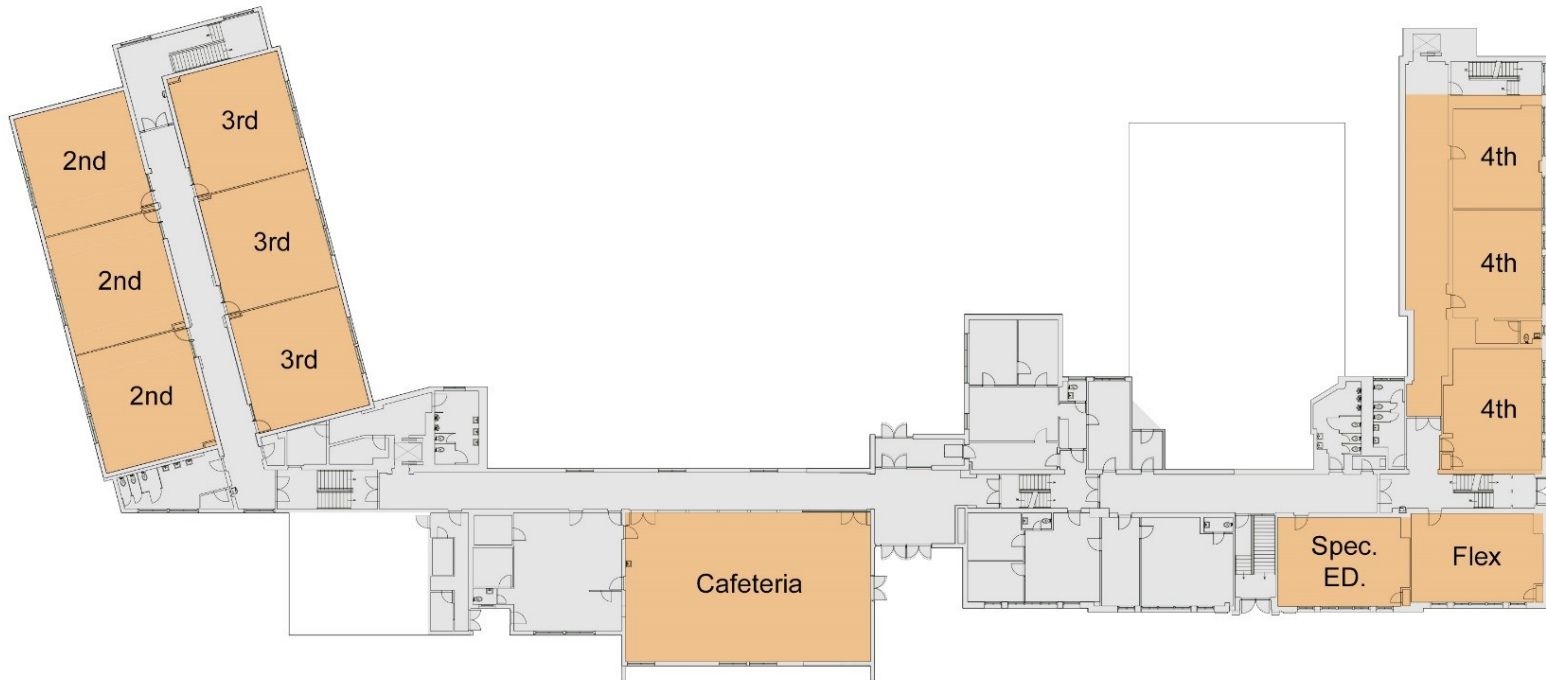

First Floor Plan



Cafeteria

Tier 1

- Very limited scope beyond Building Condition Survey corrective work
- Replace finishes
- Use furniture to create program options



Tier 2

- Design for flexibility in program: Acoustics, A/V, room dividers

Tier 3

- Higher Ed model multi-use space with state-of-the-art dedicated technology

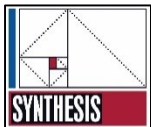



Cafeteria

Tier 1 Renovations

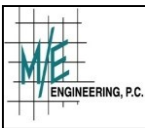
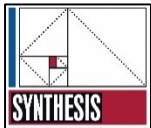



Cafeteria

Tier 2 Renovations

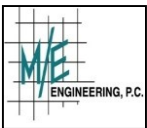
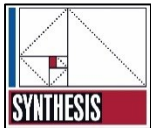
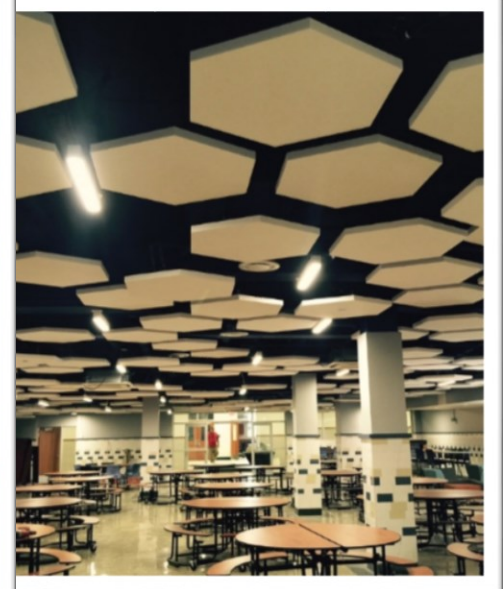
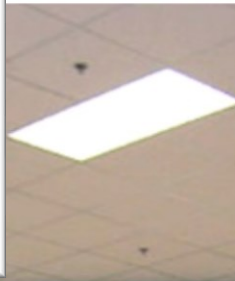



Cafeteria

Tier 3 Renovations

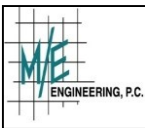
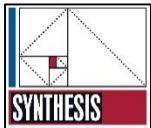
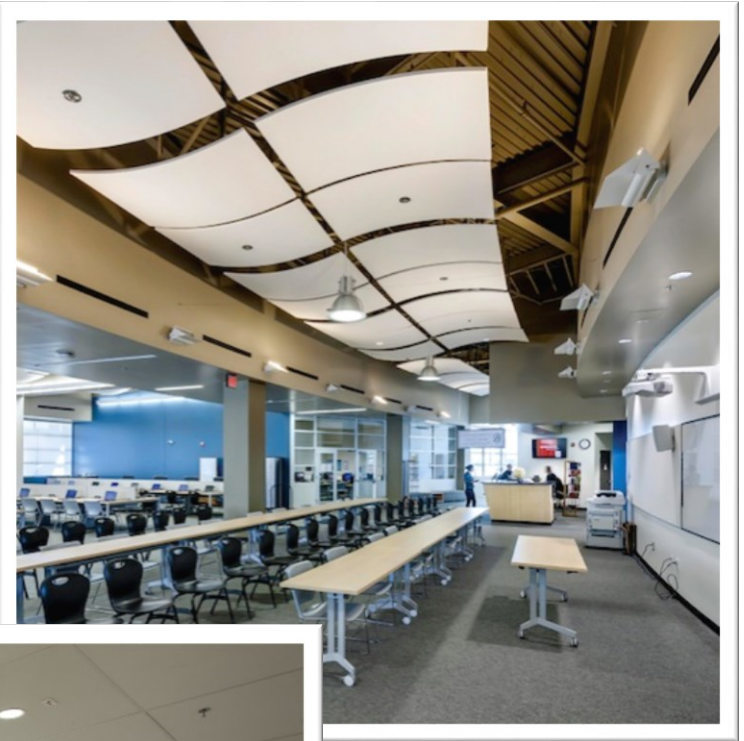
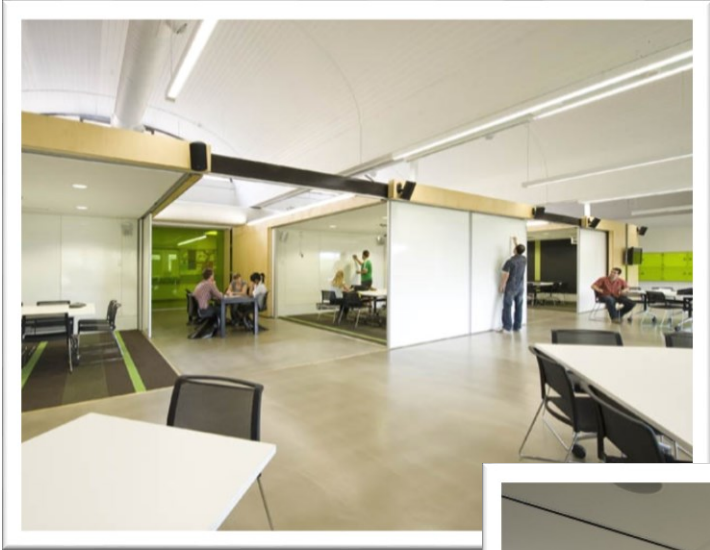



Dedicated Elementary Science Space

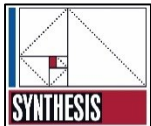
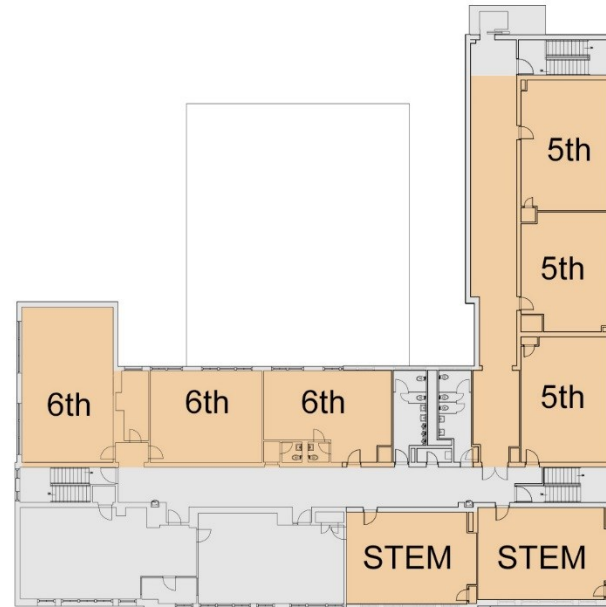

Second Floor Plan



Dedicated Elementary Science Space

Tier 1

- Very limited scope beyond Building Condition Survey corrective work
- Replace finishes and lighting
- Use furniture to create program options

Tier 2

- Functioning lab environment with spaces that provide for variations in instruction and project based learning



Tier 3

- Advanced lab environment with components that support a unique program

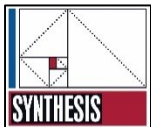
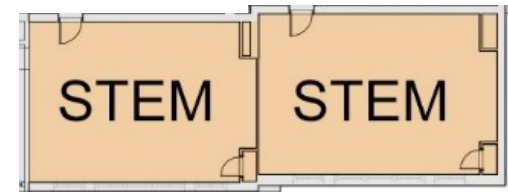



Dedicated Elementary Science Space

Tier 1 Renovations

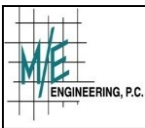
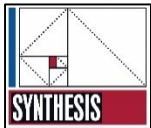



Dedicated Elementary Science Space

Tier 2 Renovations

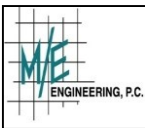
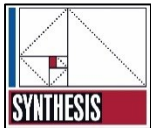
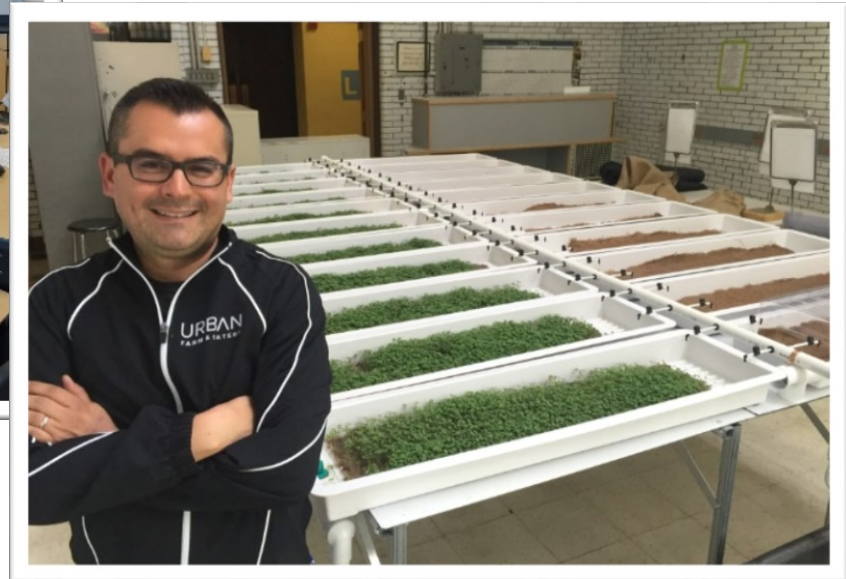



Dedicated Elementary Science Space

Tier 3 Renovations

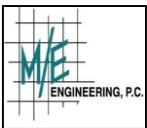
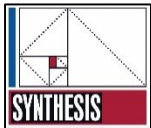



Secondary School

Reconfiguration / Modernization

- Distance learning and improved community access
- Provide large group instruction area
- Reinforce 7-8 MS Wing, Separate 9-12 HS Wing
- Improve opportunities for small group and interdisciplinary collaboration
 - Co-locate support spaces and Spec. Ed.
 - Provide Spec. Ed. spaces that support project based learning
 - Maintain large classrooms for math and sciences
 - Provide smaller instruction/project work rooms for English and History
 - Provide spaces that support teacher collaboration

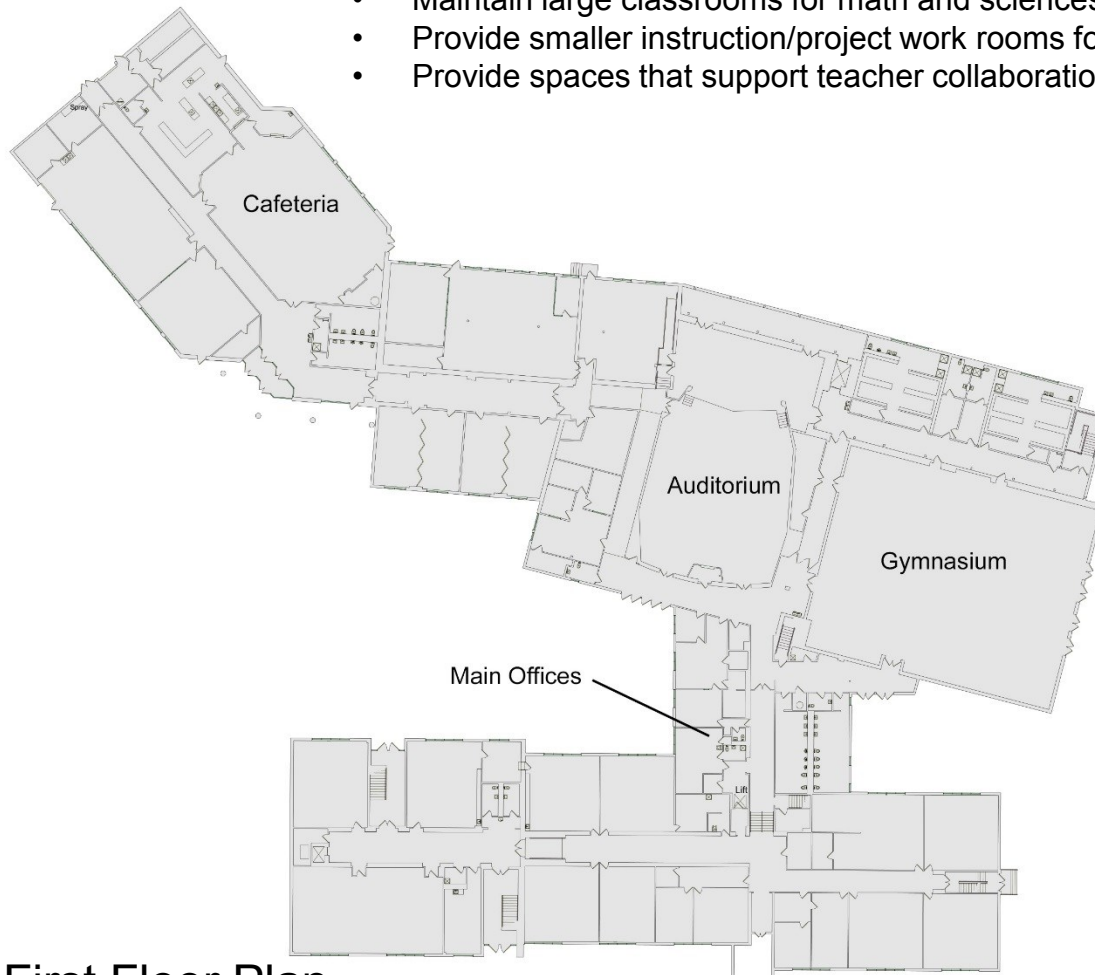

First Floor Plan

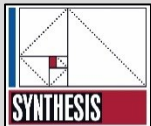



Secondary School

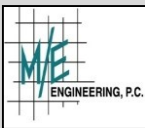
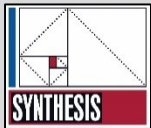
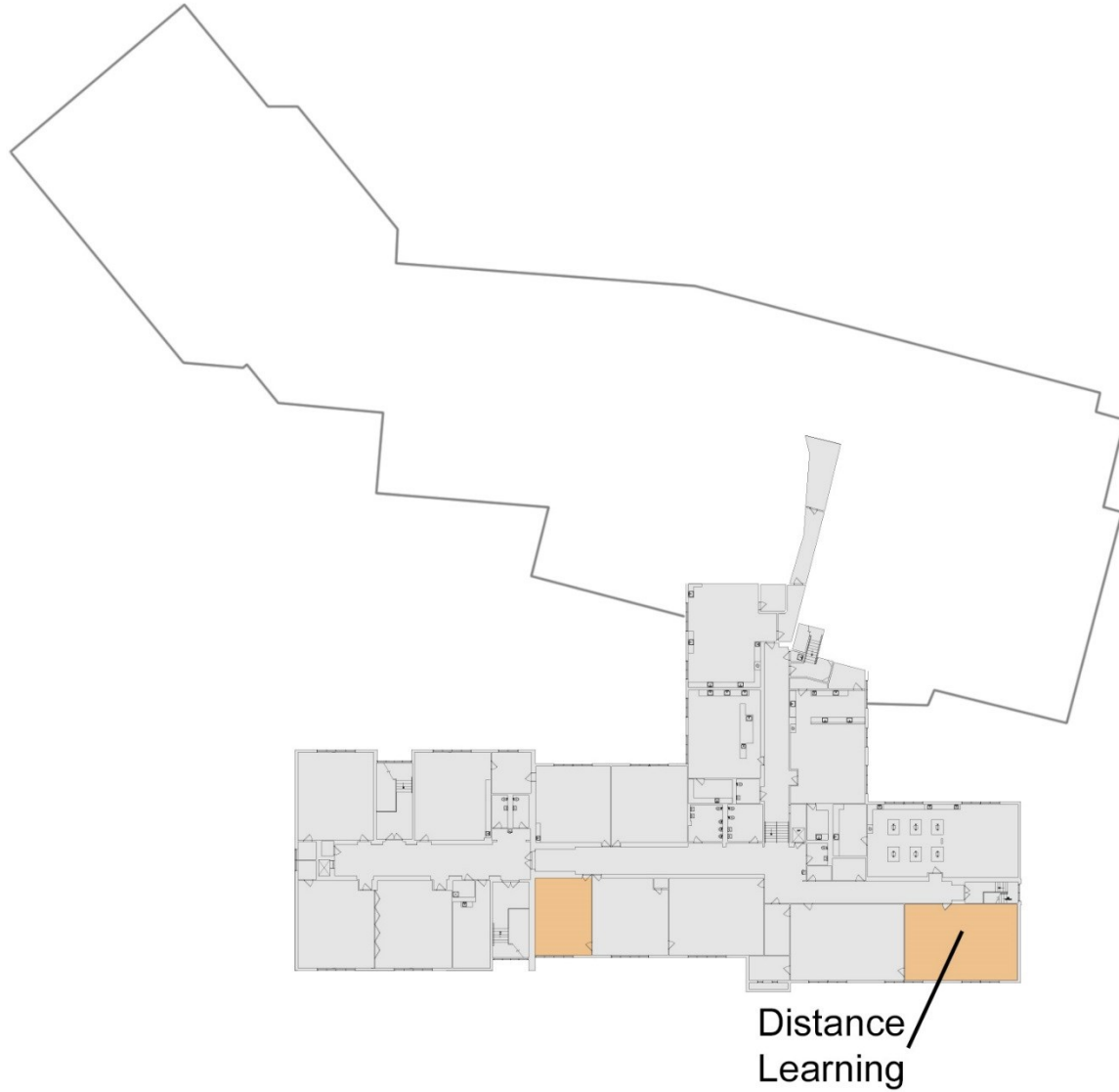

Second Floor Plan



Educational Program Cost of Work (Project 3)

Campus

- Elementary School
 - Educational Program \$ 4,500,000

Note: This work is contingent upon Project 1 Being Completed
- Secondary School
 - Educational Program \$ 275,000

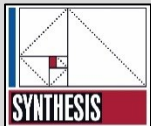

Total Cost for Educational Program: \$4,775,000

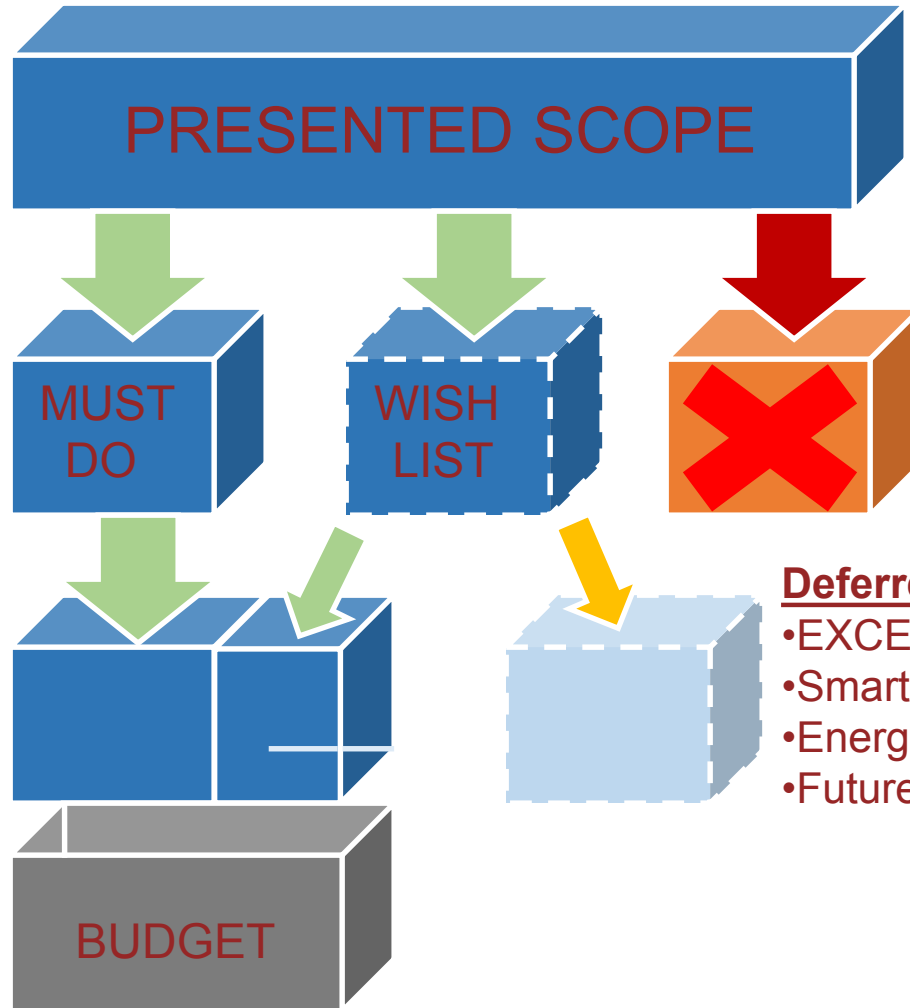

Deferred Wish List

- EXCEL Project
- Smart Schools
- Energy Performance Contract
- Future Capital Project

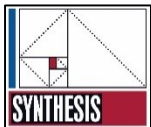



Overview of Pre-Referendum Process

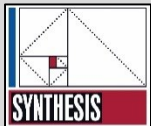
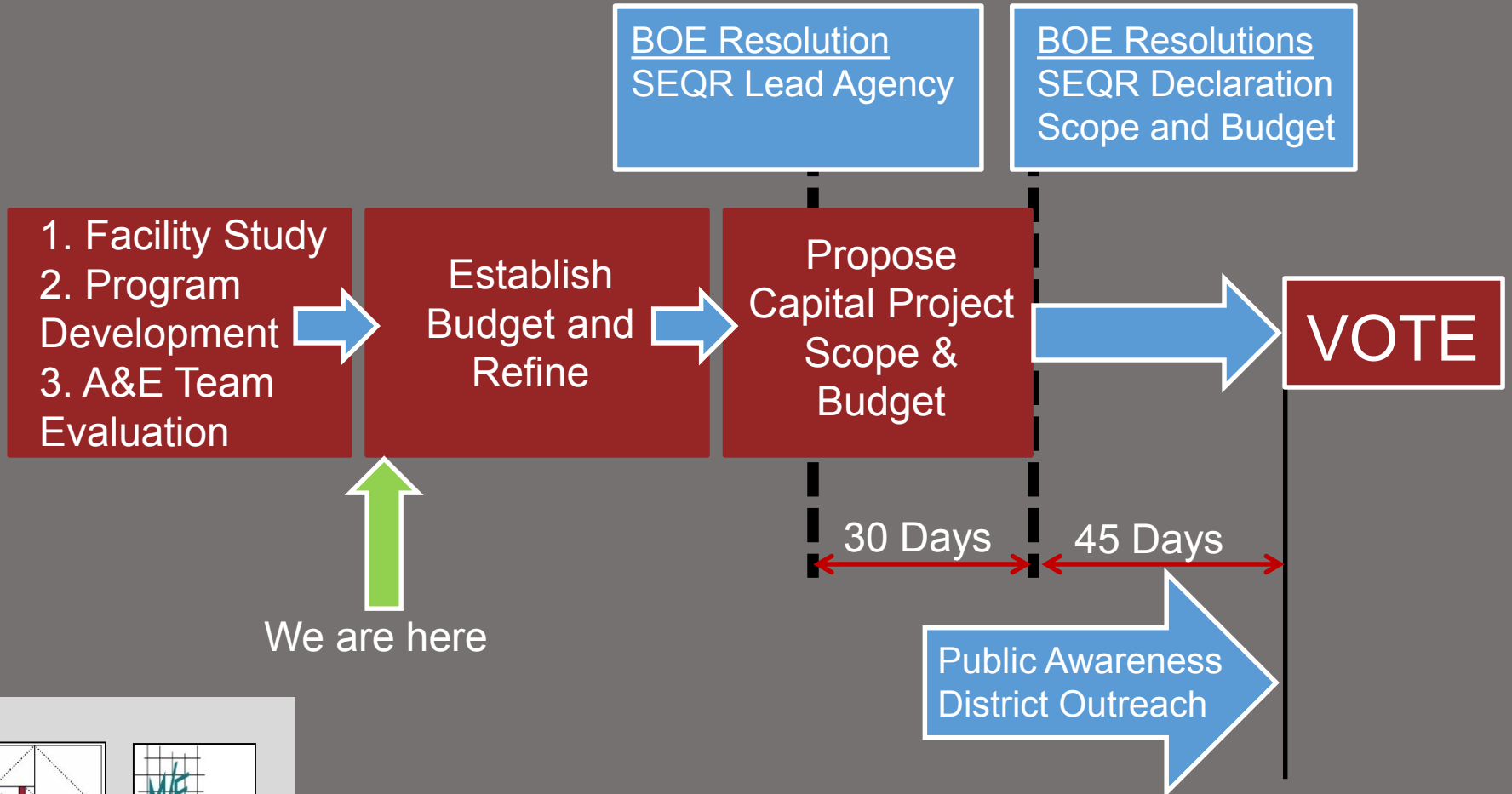



WORKSHOP

January 30, 2017

GOALS:

- Discuss the Board's and Administration's Vision.
- Gain an understanding of how program areas were viewed and developed in the preliminary listing of project scope.
- Provide the design team direction at the conclusion of the workshop.

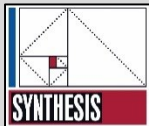



Summary Cost of Work

Campus

- Elementary School
 - Infrastructure (Project 1) \$ 6,300,000
 - Safety and Security (Project 2) \$ 1,250,000
 - Educational Program (Project 3) \$ 4,500,000
 - Organiz. Improvements (Project 4) \$ 385,000
 - \$12,435,000

- Secondary School
 - Infrastructure (Project 1) \$ 700,000
 - Safety and Security (Project 2) \$ 900,000
 - Educational Program (Project 3) \$ 275,000
 - Organiz. Improvements (Project 4) \$ 190,000
 - \$ 2,065,000

- Bus Garage
 - Infrastructure (Project 1) \$ 160,000
 - Organiz. Improvements (Project 4) \$ 375,000
 - \$ 535,000

- Site Safety and Security \$ 1M to 2M TBD

Total Cost: \$16,035,000 to \$17,035,000

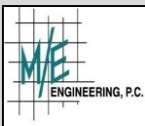
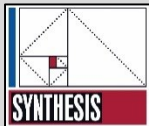



Priorities

1 Infrastructure (Project 1)

- Identified in the NYSED Building Condition Survey:
 - Life safety
 - Occupant health and well-being
 - Building systems and envelope integrity

2 Safety and Security (Project 2)

- Building security
- Traffic and pedestrian safety

3. Improvements to Educational Program (Project 3)

- Reconfiguration and/or modernization
- Technology enhancements
- Contingent upon Project 1

4. Long Range Organizational Improvements (Project 4)

- Relocation of services, reconfiguration and/or modernization

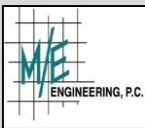
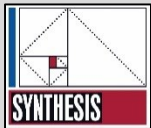



Cost of Work

- Cost of Work Includes
 - Hazardous Material Abatement
 - Identified Scope of Work
 - Design and Construction Contingency
 - Escalation
 - Incidentals

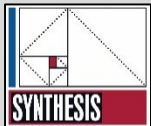



Elementary

- Replace failing sidewalks
- Repair failing exterior walls
- Replace exterior doors
- Rebuild exterior stairs and ramps
- Replace several areas of roof
- Replace all electrical distribution and branch circuiting
- Replace electrical service switch

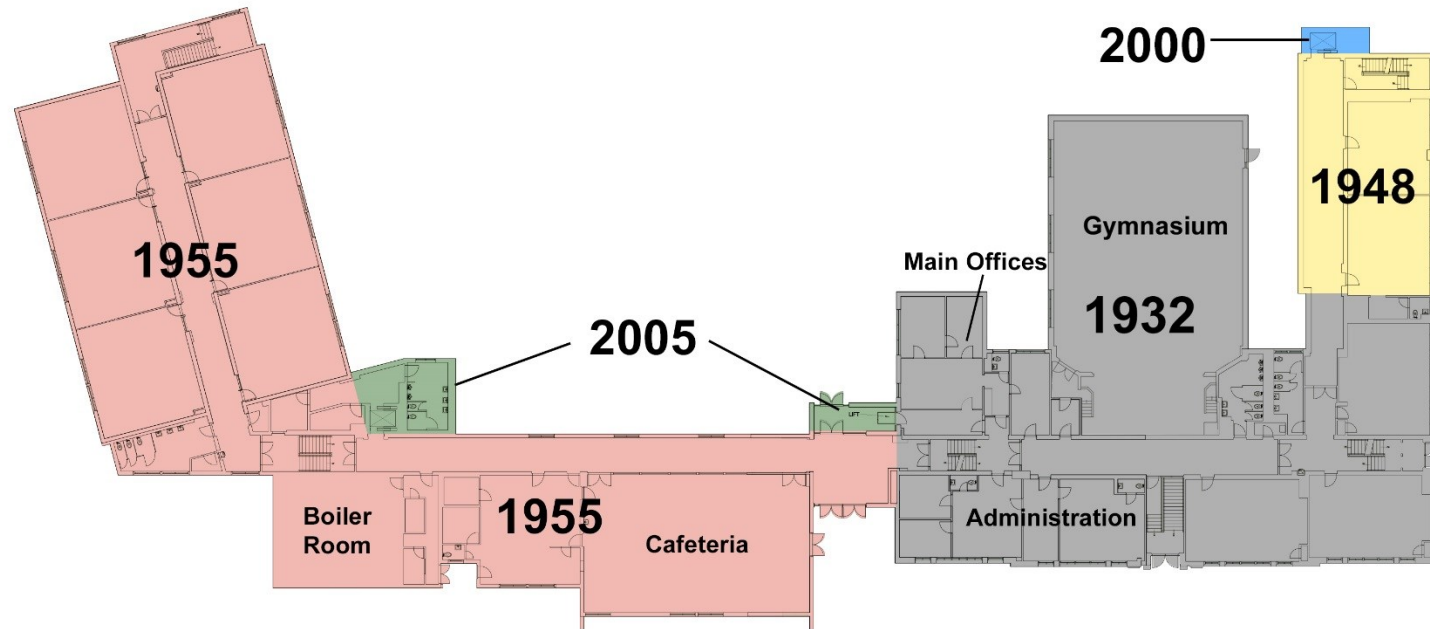

- Replace hot water heaters
- Replace water distribution system mains
- Replace plumbing drainage mains, branches and stacks
- Replace plumbing fixtures and trim throughout
- Water pressure
- Septic system
- Replace air handling/ventilation equipment
- Replace all steam and condensate with hot water
- Boilers (Included above)

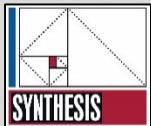

First Floor Plan



Secondary School

- Repair failing exterior walls
- Replace limited exterior doors
- Recoat 2005 roof area
- Replace remaining corridor lockers
- Replace outside phone switch and intercom PA
- Replace water heaters
- Ceiling and fire-proofing abatement

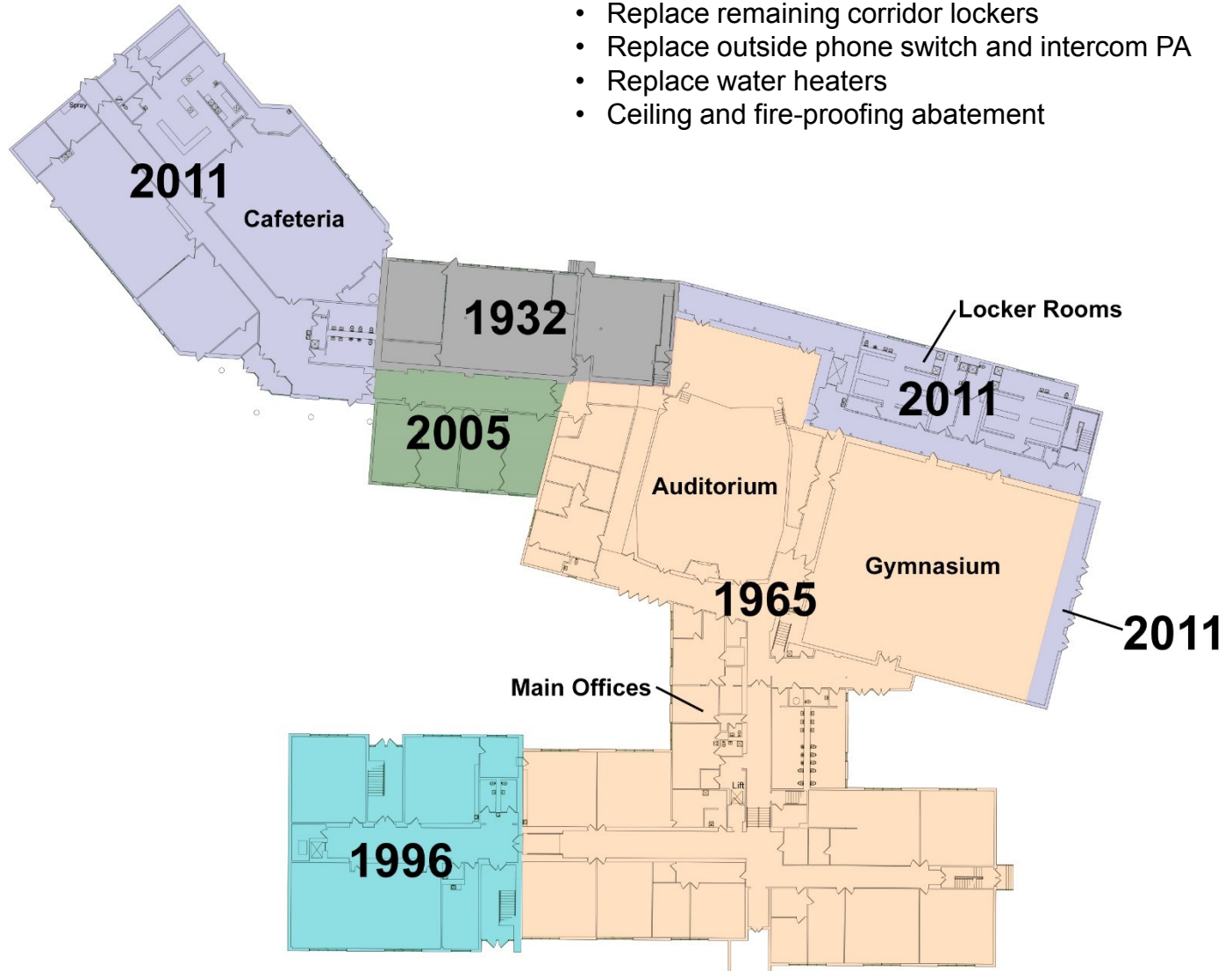

First Floor Plan

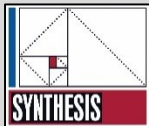



Bus Garage

- Plumbing Fixtures
- Fire Alarm System
- Interior Accessible Route

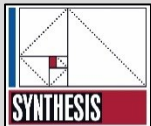
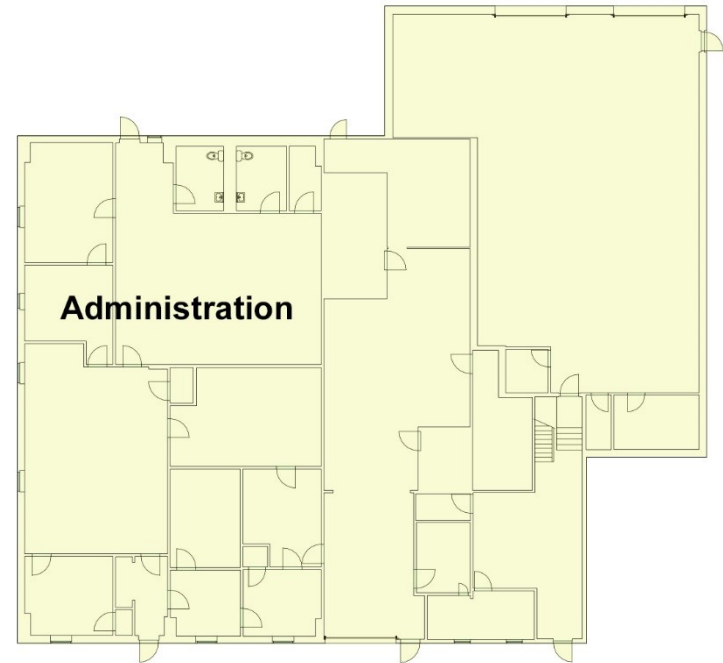

Bus Garage Floor Plan



Infrastructure Cost of Work (Project 1)

Campus

- Elementary School
 - Infrastructure \$6,300,000

- Secondary School
 - Infrastructure \$ 700,000

- Bus Garage
 - Infrastructure \$ 160,000

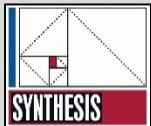

Total Cost for Infrastructure:

\$7,160,000